



INTERTHOR

THORK LIFT HL / EHL

60 years experience with
LIFTING PERFORMANCE

interthor.com

Manual/electric Thork Lift - optimum working height

The Thork Lift can transport and lift a pallet to the right ergonomic working height: Loads of 3300 lbs can be transported and lifted up to 18.5 inches. From 18.5 inches the lifting capacity is 2200 lbs.

The ergonomic working conditions of the user is in focus. The working height can be varied up to 31.5 inches, and the user is given the opportunity for individual height adjustment, protecting his back and shoulders. Lifting is done either manually (HL) or electrically (EHL).

The electric Thork Lift can be provided with remote control and level control, automatically maintaining a correct working height, so that the user is constantly provided an ergonomically correct working position. Using the level control, the forks raise automatically when unloading material and lower when loading material.



INTERTHOR

THORK LIFT HL / EHL

Ergonomics

- The working height can be adjusted
- Ergonomically correct handle
- Very low power for pump function (HL)/ electric pump function (EHL)

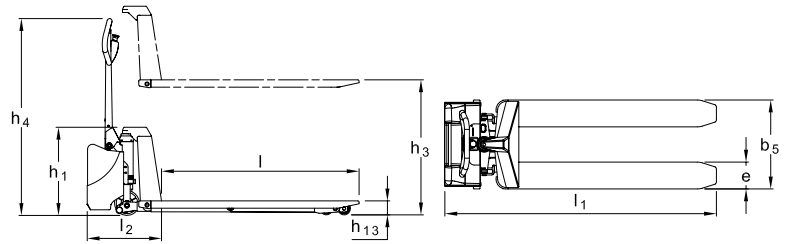

Safety

- Foot protection
- Low overall height
- Supporting feet at steering wheel
- Tandem wheels on scissors legs

Durability

- Long operating life
- Low maintenance costs
- Reliable cylinder construction
- Strong construction



The emergency stop is centrally placed on the electric Thork Lift. The forks stop quickly and precisely.



The manual Thork Lift needs very low power for the pump function and has foot protection and neutral position.



Ergonomic handle ensures the user a relaxed hold. Central location of all control buttons in the handle.



The tandem wheels have a brake effect and are gentle to the floor.



Level control (optional extra) ensures a constant working height.



Available as manual, electric, inox and explosion proof.

Product (measured in inch)		HL 1006					EHL 1004				
Capacity in lbs		3300*				2200	3300*				2200
Lifting height	h_3	19.5	23.5	31.5	31.5	31.5	19.5	23.5	31.5	31.5	31.5
Fork length	l	27.5	35.5	47	60	79	27.5	35.5	47	60	79
Overall height	h_1	21.25					21.25				
Fork span	b_5	19, 21.25, 27				21.25, 27	19, 21.25, 27				21.25, 27
Length without forks	l_2	14					17.75				
Overall length	l_1	41.5	49.5	61.25	74	92.75	45.25	53.25	65	77.5	96.5
Overall height with handle	h_4	48.25					47				
Lowered height	h_{13}	3.25				3.5	3.25				3.5
Fork width	e	6.5					6.5				
Turning angle of the wheels		230°					180°				
Gangway	A_{st}	72 (pallet: 47 x 31.5)					74.5 (pallet: 47 x 31.5)				
Lifting speed with/without load		-					2" / 3.2" per sec.				
Lifting speed normal/quick		0.4" / 1.4" per pump					-				
Lowering speed		Without load 3.5" per sec.					With / without load: 2.75" / 2" per sec.				
Pump motor		-					1,2 kW 12 V				
Weight with 47" forks		209 lbs					229 lbs (no battery)				

* The capacity changes from 3300 to 2200 lbs at the lifting height 18.5".